

Drain: WEAVER ; HOCKE **Drain #:** 23
Improvement/Arm: DURBIN ELEMENTARY RELOCATION
Operator: J. LIVINGSTON **Date:** 8-16-04
Drain Classification: Urban/Rural **Year Installed:** 1998

GIS Drain Input Checklist

- Pull Source Documents for Scanning JL
- Digitize & Attribute Tile Drains JL
- Digitize & Attribute Storm Drains JL
- Digitize & Attribute SSD JL
- Digitize & Attribute Open Ditch JL
- Stamp Plans JL
- Sum drain lengths & Validate JL
- Enter Improvements into Posse JL
- Enter Drain Age into Posse JL
- Sum drain length for Watershed in Posse JL
- Check Database entries for errors JL

Gasb 34 Footages for Historical Cost
Drain Length Log

Drain-Improvement: WEAVER : HOOKE - DURBIN ELEMENTARY RELOCATION

					If Applicable	
Drain Type:	Size:	Length	Length (DB Query)	Length Reconcile	Price:	Cost:
PVC	10"	175'	182'	+7'		
Sum:		<u>175'</u>	<u>182'</u>	<u>+7'</u>		<u>1800'</u>

Final Report: _____

Comments:

LENGTH OF DRAIN IN SURVEYOR'S REPORTS DOES NOT MATCH LENGTH
OBTAINED IN AERIAL SURVEY PERFORMED BY THIS OFFICE.



SURVEYOR'S OFFICE
Hamilton County

Kenton C. Ward, Surveyor

Suite 146

776-8495

One Hamilton County Square

Noblesville, Indiana 46060-2230

October 20, 1995

To: Hamilton County Drainage Board

Re: Weaver-Hooke Drain

Attached is a petition for reconstruction of the Weaver-Hooke Drain along with plans for the proposed work. The relocation is being petitioned by Hamilton Southeastern Schools.

The proposal is to intercept the drain at STA 6+60 of Arm 2 and relocate the drain to STA 8+20 of Arm 2. This portion of the drain runs parallel to Middletown Ave. The relocated drain will be placed 10 feet south of the original drain so as to allow for expansion of the Durbin Elementary School. This relocation will add approximately 15 feet to the drain's length. The relocated drain will be 10' PVC.

A Performance Bond has been filed with The County Commissioners for the amount of \$1800.00 for a period of 2 years. Bond is from Peerless Insurance, Bond No. 018 70 99 04 dated October 19, 1995.

The cost of the relocation is to be paid by Hamilton Southeastern Schools. Because the project is to be paid by the petitioner and is within the boundaries of the petitioner's property the project falls under the requirements as set out in IC 36-9-27-52.5. Therefore, a hearing is not required for the petition. I recommend approval by the Board at this time.

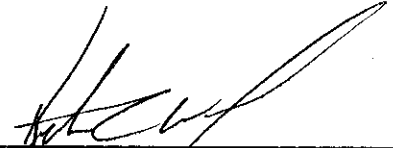

Kenton C. Ward
Hamilton County Surveyor

KCW/nw

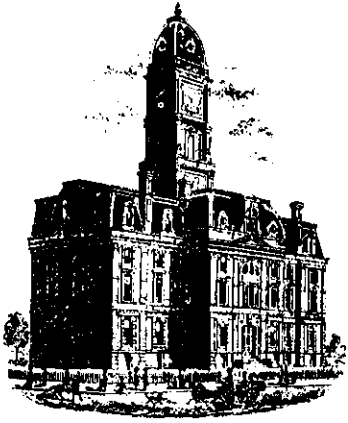

SURVEYOR'S OFFICE
Hamilton County

Kenton C. Ward, Surveyor

Phone (317) 776-8495

Fax (317) 776-9628

Suite 146

One Hamilton County Square

Noblesville, Indiana 46060-2230

To: Hamilton County Drainage Board

April 8, 1998

**Re: Weaver & Hooke Drain: Durbin Elementary
Relocation**

Attached are as-builts, certificate of completion & compliance, and other information for the Durbin Elementary Relocation of the Weaver & Hooke Drain. An inspection of the drainage facilities for this section has been made and the facilities were found to be complete and acceptable.

During construction, changes there were no significant changes made to the drainage plans submitted with my report for this drain dated October 20, 1995.

Therefore, the additional length of the drain remains at **15 feet**.

The non-enforcement was approved by the Board at its meeting on November 27, 1995 and recorded under instrument #9562402.

The bond or letter of credit from Peerless Insurance, number 018-70-99-04; in the amount of \$1800.00; was released April 13, 1998.

I recommend the Board approve the drains construction as complete and acceptable.

Sincerely,

Kenton C. Ward,
Hamilton County Surveyor

KCW/slm

Field Surveyor:
J.W. F.M.
Computer Operator:
J.W.
Reference:

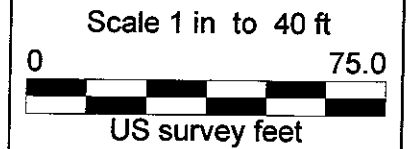
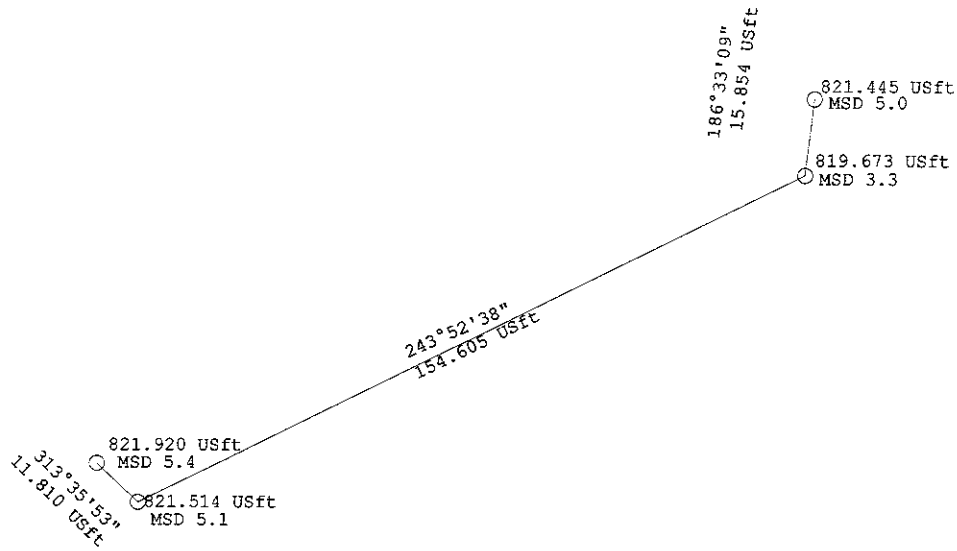

0°00'00"

Plot Scale: 1 in to 40 ft
Printed on 3/6/98, at 10:04:51 AM

Printed from Trimble Survey Office

Site: Not selected, System: United States State Plane 1983
Zone: Indiana East 1301, Datum: North American 1983 (Conus)

Project: Durbin
USFeet Template

One Hamilton Co. Square, Ste. 188, Noblesville, In 46060

- CONTRACTOR SHALL FURNISH AND INSTALL CAST IRON BOOTS AT ALL DOWNSPOUTS. PROVIDE SHAPE AND SIZE AS REQUIRED, AND PROVIDE ALL FITTINGS AND OTHER INCIDENTALS FOR A COMPLETE INSTALLATION. GROUT TOP OF BOOTS TO DOWNSPOUTS, CROWNED TO SHED WATER.
- CONTRACTOR SHALL FURNISH AND INSTALL ALL WORK REQUIRED TO CONNECT EXISTING DOWNSPOUTS AT THE MIDDLE AND SOUTH CANOPIES INTO EXISTING BUILDING PERIMETER DRAINAGE SYSTEM. SEE DRAWING SHEET SUIT FOR NOTES REGARDING MATERIALS, SIZE, MANUFACTURERS, AND OTHER DATA TO BE USED.

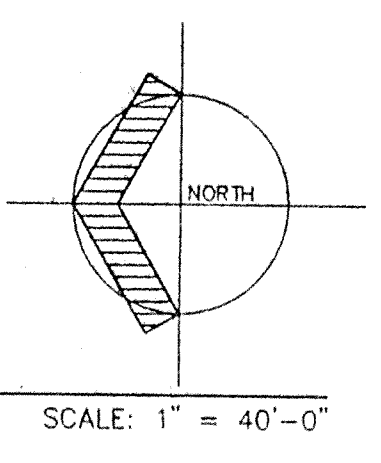

STORM SEWER LAYOUT

HAMILTON COUNTY INDIANA

This information was gathered for input into the Hamilton County Geographical Information System. This document is considered an official record of the GIS.

Entry Date: 8-16-04

Entered by: [Signature]

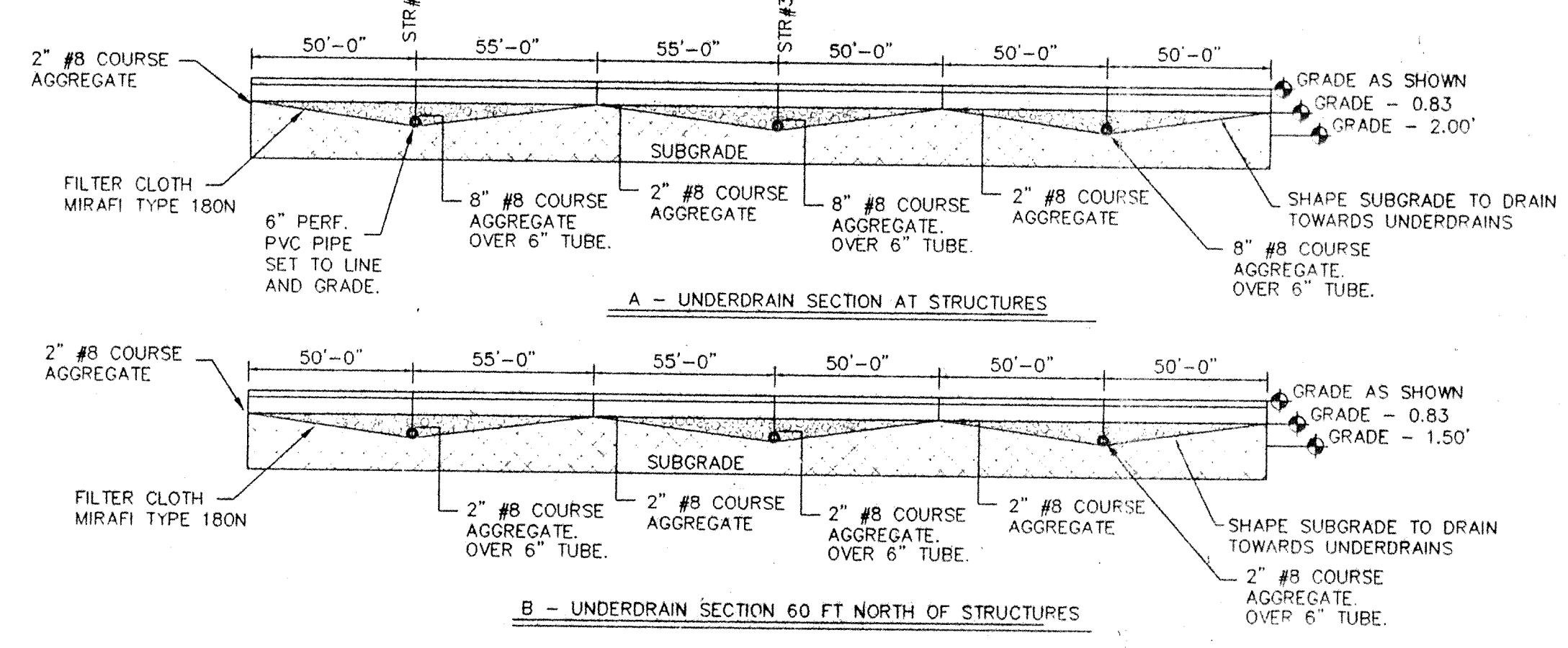

1 SUBGRADE GRADING FOR UNDERDRAINS

REVISION NOTES

- (A) NOTED SECTION TO DUCTILE IRON PIPE WITH COMPRESSION FITTINGS AS APPROVED BY THE ENGINEER
- (B) THE LOCATION OF THE UNDERGROUND DETENTION SYSTEM IS TO BE RELOCATED 8' TO THE EAST AND 48' TO THE NORTH. THE LOCATION OF THE NEW "TEE'S" REMAINS UNCHANGED. THE WEST MOST 36" STORAGE PIPE SHOULD BE ON LINE WITH THE NEW TEE'S
- (C) THE INVERTS FOR THE NEW TEES TO BE UNCHANGED. NEW RIM ELEVATIONS TO BE 820.90
- (D) THE PIPING FOR THE RELOCATED PORTION OF THE LEGAL DRAIN TO BE DUCTILE IRON PIPE WITH COMPRESSION FITTINGS - APPROXIMATELY 80 LFT
- (E) REFER TO PROJECT ADDENDUMS REGARDING ACCEPTABLE STORM PIPING MANUFACTURERS
- (F) NOTED SECTION TO BE PVC, HDPE OR RCP AS APPROVED BY THE ENGINEER.

SUMMARY OF REVISIONS

- ADD**
 - ADD 181 LFT OF 12" PIPE FROM INLET STRUCTURE #8 TO THE HEADER PIPE AT NEW LOCATION. THIS PIPING TO BE DUCTILE IRON PIPE WITH COMPRESSION FITTINGS
 - ADD 69 LFT OF 10" PIPE FROM THE HEADER PIPE TO THE EXISTING OUTLET STRUCTURE. THIS PIPING TO BE PVC OR HDPE PIPE
 - ADD 80 LFT OF DUCTILE IRON PIPE WITH COMPRESSION FITTINGS FROM THE WEST CLEANOUT OF THE LEGAL DRAIN TO APPROXIMATELY 80 FT EASTERLY.
 - ADD 6- 36"x36"x24" TEES WITH CONCRETE CAP AND CASTING SEE RSU1.2
 - ADD 140 LFT OF 6" DUCTILE IRON PIPE FROM STRUCTURE #8 TO ROOF DRAIN.
- DELETE**
 - DELETE 131 LFT OF 12" PIPE FROM INLET STRUCTURE NUMBER 8 TO THE HEADER PIPE
 - DELETE 15 LFT OF 10" PIPE FROM THE HEADER PIPE TO INLET STRUCTURE #7
 - DELETE 35 LFT OF 12" PIPE FROM INLET STRUCTURE #7 TO THE EXISTING OUTLET STRUCTURE
 - DELETE 115 LFT OF 12" PIPE FROM INLET STRUCTURE #1 TO M.H./IN. 1
 - DELETE STRUCTURE #7
 - DELETE 10 LFT OF 3" PERFORATED PIPE.
 - DELETE ALL REFERENCES TO THE SOUTH INVERT OF STRUCTURE #1
 - DELETE 80 LFT OF 12" STARTING FROM THE WEST CLEANOUT AND HEADING EASTERLY.
 - DELETE 6 SHALLOW MANHOLE/INLETS 1 THRU 6 AND CASTINGS

NOTE:
SLOPE OF EXISTING DRAIN TILE IS ESTIMATED BETWEEN THE 2 EXISTING STRUCTURES WHERE THE TILE IS KNOWN TO LAP. THE PROPOSED NEW TILE SLOPE IS TO MATCH THE EXISTING. THE CONTRACTOR SHALL EXPOSE AND FIELD VERIFY THE PROPOSED INVERTS PRIOR TO ABANDONING THE EXISTING SECTION. THE ABANDONED SECTION SHALL BE FILLED USING A FLOWABLE MORTAR.

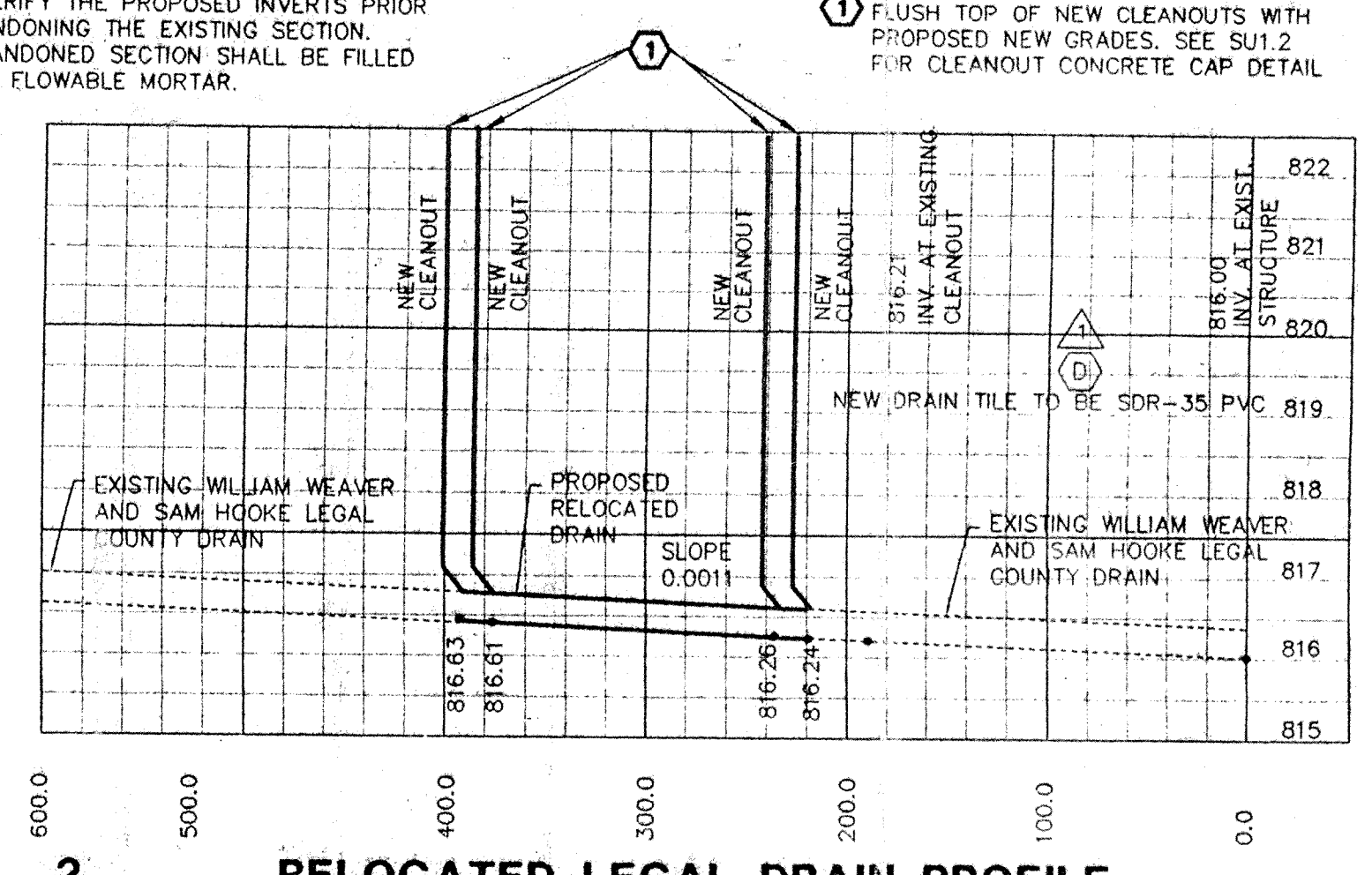

2 RELOCATED LEGAL DRAIN PROFILE

BASED ON AVAILABLE DATA, THE LEGAL DRAIN IS ASSUMED TO INVERT AT THIS CLEANOUT. SHOULD DIFFERING SITE CONDITIONS PREVAIL, THE CONTRACTOR SHALL CONTACT STEVE BENAUGH AT 317-776-8495 HAMILTON COUNTY SURVEYORS OFFICE 48 HRS PRIOR TO BACKFILLING THE LEGAL DRAIN TILE.

NOTES:

- STORM PIPING ON THIS PROJECT SHALL BE MANUFACTURED BY HANCOR EXCEPT UNDERDRAIN LINES.
- STORM DRAIN PIPING SHALL BE HI-0 SURE-LOK 2.0 WITH BELL AND SPIGOT CONNECTIONS.
- UNDERDRAIN PIPE SHALL BE 6" PERFORATED PVC, FILTER WRAPPED INSTALLED IN 10'-0" OR 20'-0" SECTIONS SET TO LINE AND GRADE AS SHOWN OR DIRECTED DOWNSPOUT TO PERIMETER DRAIN PIPING SHALL BE 6"

LEGEND:

- (C) = RODDING HOLE/CLEANOUT
- (1) 6" DOWNSPOUT LEADER TO PERIMETER DRAIN. PROVIDE POSITIVE DRAINAGE TO PERIMETER DRAIN.
- (2) 8" PERIMETER DRAIN SLOPE AT 0.0020 OR MEET INVERT AS SHOWN
- (3) 10" PERIMETER DRAIN SLOPE AT 0.0020 OR MEET INVERT AS SHOWN
- (4) SUBGRADE ELEVATION = GRADE ELEVATION - 0.83'

FILED
FEB 09 1996
OFFICE OF HAMILTON COUNTY SURVEYOR

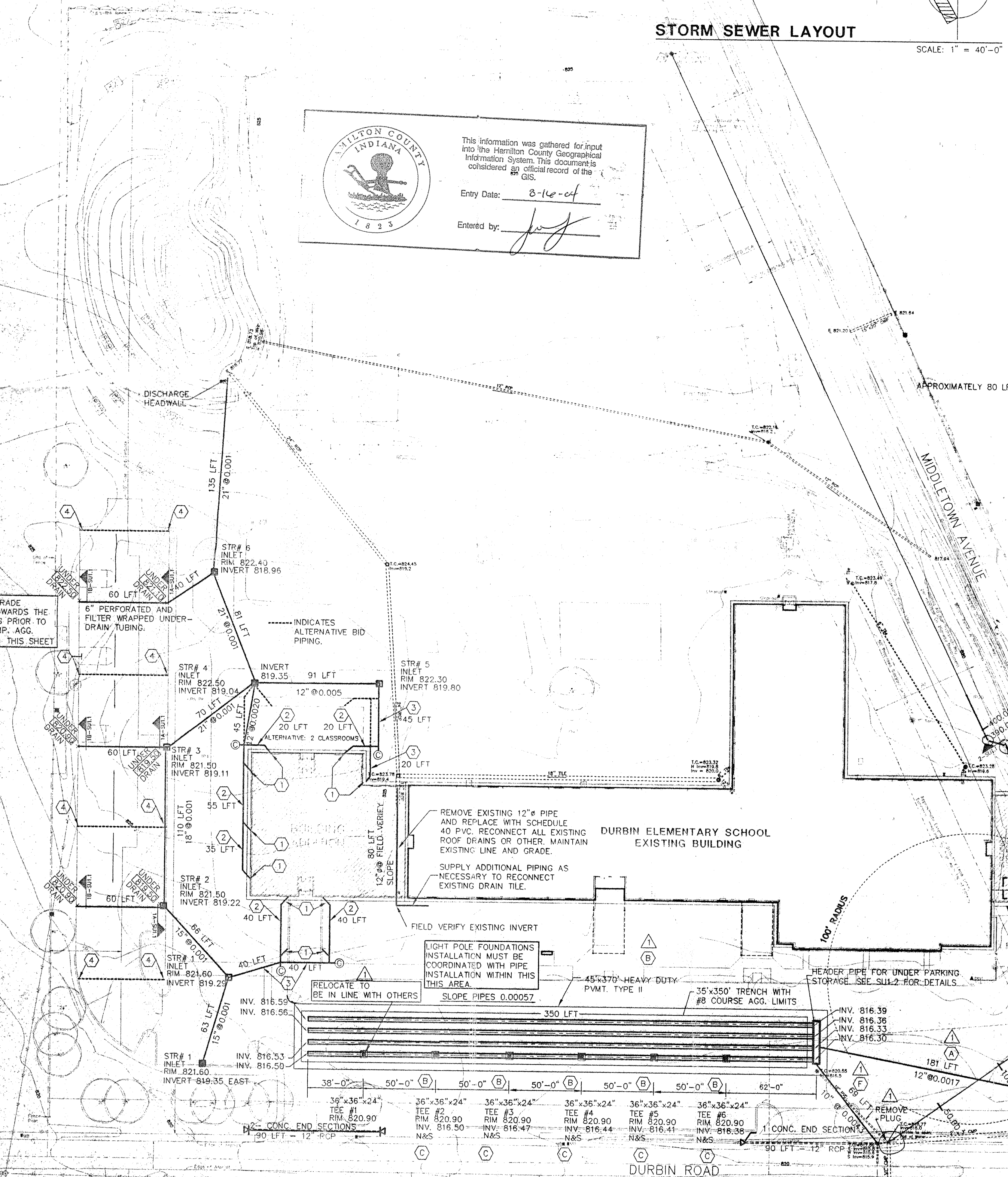

SUBGRADE DRAIN TOWARDS THE DRAINS PRIOR TO 10'-0" COMP. AGG. DETAIL 1 THIS SHEET

INDICATES ALTERNATIVE BID PIPING.

REMOVE EXISTING 12" PIPE AND REPLACE WITH SCHEDULE 40 PVC. RECONNECT ALL EXISTING ROOF DRAINS OR OTHER. MAINTAIN EXISTING LINE AND GRADE.

SUPPLY ADDITIONAL PIPING AS NECESSARY TO RECONNECT EXISTING DRAIN TILE.

LIGHT POLE FOUNDATIONS INSTALLATION MUST BE COORDINATED WITH PIPE INSTALLATION WITHIN THIS AREA.

REQUIRES 4-RODDING HOLES, ONE AT EACH CHANGE OF DIRECTION. 10" SDR-35, PVC PIPE APPROXIMATELY 80 LFT

FLUSH TOP OF NEW CLEANOUTS WITH PROPOSED NEW GRADES. SEE SU1.2 FOR CLEANOUT CONCRETE CAP DETAIL

36"x36"x24"	36"x36"x24"	36"x36"x24"	36"x36"x24"	36"x36"x24"	36"x36"x24"	36"x36"x24"
TEE #1	TEE #2	TEE #3	TEE #4	TEE #5	TEE #6	TEE #6
RIM 820.90	RIM 820.90	RIM 820.90	RIM 820.90	RIM 820.90	RIM 820.90	RIM 820.90
INV. 816.56	INV. 816.47	INV. 816.44	INV. 816.38	INV. 816.41	INV. 816.38	INV. 816.38
N&S	N&S	N&S	N&S	N&S	N&S	N&S

PHASE 1- ADDITIONS AND RENOVATION TO
DURBIN ELEMENTARY SCHOOL
 DURBIN, INDIANA
 HAMILTON SOUTHEASTERN SCHOOLS
 NOBLESVILLE, INDIANA

Fanning/Howey Associates, Inc.
 Architects Engineers Consultants

STORM SEWER LAYOUT
 DRAWN BY: JWP
 CHECKED BY: JWP
 COMM. NO.: 95050.00
 DATE: 12-12-95

RSU1.1
 REVISIONS NO. DATE
 01-30-96

DURBIN ELEMENTARY SCHOOL
 95050.00

COPYRIGHT 1995 BY FANNING/HOWEY ASSOCIATES, INC.